

BANDEX HEAT SHRINKING SLEEVE

ท่อหดหุ้มบัสบาร์

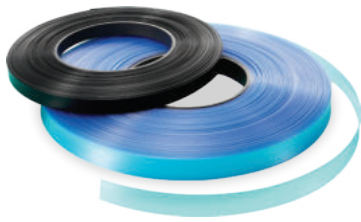

R: RED W: White BL:Blue B: Black
G: Green Y: Yellow
BN : Brown LE : Light Blue
GY : Gray

- Material: Rigid Shrinkable P.V.C.
- Used for colour distinction and insulation of busbar in control panel. To be shrinked by blower or hot water.
- Maximum service temp : 80°C

Item no.	Lay flat dimension	Convert to dia.	Shrinkable range	For copper bus bar/size	Color	Packing	Price
HS-20	20	13	21-11	1/2" x 1/8", 3/16" x 1/2"A, 1/2" x 1/4"	R, W, B, BK Y, G, BN, GN, LB	100 M	350.-
HS-30	30	19	31-16	3/4" x 1/8", 3/4" x 3/16", 3/4" x 1/4", 1" x 1/8", 1" x 3/16"			378.-
HS-40	40	25	40-22	1 1/4" x 1/8", 1 1/4" x 3/16", 1 1/4" x 1/4", 1 1/2" x 1/8"			420.-
HS-50	50	-	-	1 1/4" x 1/4", 1 1/2" x 3/16", 1 1/2" x 1/4", 1 1/2" x 3/8"			530.-
HS-60	60	38	60-33	2" x 1/8", 2" x 3/16", 2" x 1/4", 2" x 3/8", 2" x 1/2"			560.-
HS-70	70	44	70-37	2 1/2" x 1/8", 2 1/2" x 3/16", 2 1/2" x 1/4"			770.-
HS-80	80	50	80-42	2 1/2" x 3/8", 3" x 1/4", 3" x 3/8", 3" x 1/8"			840.-
HS-100	100	63	100-55	3" x 3/16", 3" x 1/4", 3" x 3/8", 3" x 1/2"			1,050.-
HS-120	120	76	120-65	4" x 1/8", 4" x 3/8", 4" x 1/2"			1,190.-
HS-150	150	95	150-90	5" x 1/8", 5" x 3/8", 5" x 1/2"			1,400.-

CLOSE END WIRE CONNECTOR

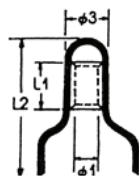

- The above size will be changed without notice if necessary.
- Material: UL approved NYLON 66,94v-2. Nylon insulated close-end wire connectors.
- To apply, insert pre-stripped wires into connector tube and crimp it with crimping tool to hold wires firmly even in vibration.

Cat. no.	ø1	ø2	ø3	L1	L2	Nominal sectional area	A.W.G	Suitable wire	Packing	Price
								Straining mm ² 2 d		
CE-1	2.4	7.8	5.1	7.5	20.0	1.25	22 -16	0.5 -1.75	100 pcs	1.55.-
CE-2	3.0	7.8	5.7	7.5	20.0	2.0	16 -14	1.0 -3.0		1.68.-
CE-5	3.8	10.5	7.3	8.5	25.3	5.5	12 -10	2.5 -6.0		2.38.-
CE-8	4.7	12.0	9.3	9.5	27.2	8.0	8.0	4.0 -9.0		6.08.-